

# VIBRATOR TECHNICAL DATA SHEET

MODEL: MVS1 15/1710-S02 230/400V 50Hz 3PH

SERIE: AC FRAME SIZE: 50 P/N: 601219A

**RPM 1500**

## MECHANICAL CHARACTERISTICS

Weights Position %	Static moment		Centrifugal Force			Bearing Life w/1.3 Load Factor	Bearing Life w/1.0 Load Factor
	kgmm	in.-lb	kg	lb	kN		
100	715	62,2	1798	3956	17,6	35607	85217
90	644	56,0	1618	3560	15,9	50589	>100000
80	572	49,7	1438	3164	14,1	74914	>100000
70	501	43,5	1259	2769	12,3	>100000	>100000
60	429	37,3	1079	2373	10,6	>100000	>100000
50	358	31,1	899	1978	8,82	>100000	>100000
40	286	24,9	719	1582	7,05	>100000	>100000
30	215	18,7	539	1187	5,29	>100000	>100000
20	143	12,4	360	791	3,53	>100000	>100000
10	72	6,2	180	396	1,76	>100000	>100000

Weight:	106 lb (48,0 kg)	Bearing:	NJ 2308 E C4
Working Moment:	124 in-lb (1430 kgmm)	Dynamic load:	28940 lb (13154 kg)
Max Static Moment:	62,2 in-lb (715 kgmm)	Lube schedule:	5000 hours

## ELECTRICAL CHARACTERISTICS

			in-lb	Nm
Nominal input voltage:	230	400	Nominal torque:	50,8   5,70
Nominal current (amps):	3,5	2,0	Start torque:	112   12,5
Start current (amps):	15,0	8,6	Maximum torque:	135   15,1
Start/Nom. current ratio:	4,29		Start/nom. torque ratio:	2,19
Input power (watts):	1100		Max/nom. torque ratio:	2,65
Output power (hp):	1,1		Starting time (sec):	1,69
Service Factor:	1,0		Duty cycle:	continuous
Efficiency:	75%		Max. Ambient Temp.:	40°C (104)
Slip:	7%		Inertia (lb-ft²):	9,6445
Power factor:	0,79		Inverter Duty:	20Hz to 50Hz
Coil resist (Ω @ 20°C):	9,45		Operating Temp. Code:	See below
Insulation class:	F		Capacitance (µF):	N/A
Locked Rotor Code:	G			

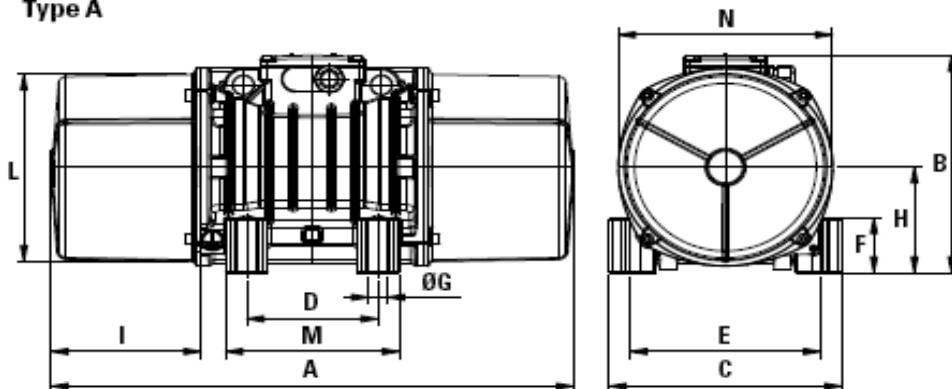

Type A



	in.	mm
A:	19,69	500
B:	9,61	244
C:	9,06	230
D:	5,51	140
E:	7,48	190
ØG:	0,67	17
F:	1,77	45
H:	4,57	116
I:	5,28	134
L:	8,15	207
M:	7,48	190
N:	8,86	225

External cable diam.:	9-16mm
Serv. length req.per side:	0,354-0,630 inch
Mounting bolts:	5/8" - (M16)
Mounting bolt torque:	137 ft-lb (19 kgm)

### Approvals and certifications

	ATEX 2014/34/UE II2D Ex tD A21 T150°C IP66 cert. n°LCIE 05 ATEX 6163X
	IECEx tD A21 T150°C IP66 cert. n° CES 09.0001X
	Motors and Generators. Ordinary Locations LR100948 Class 4211 01